

Reception Hall

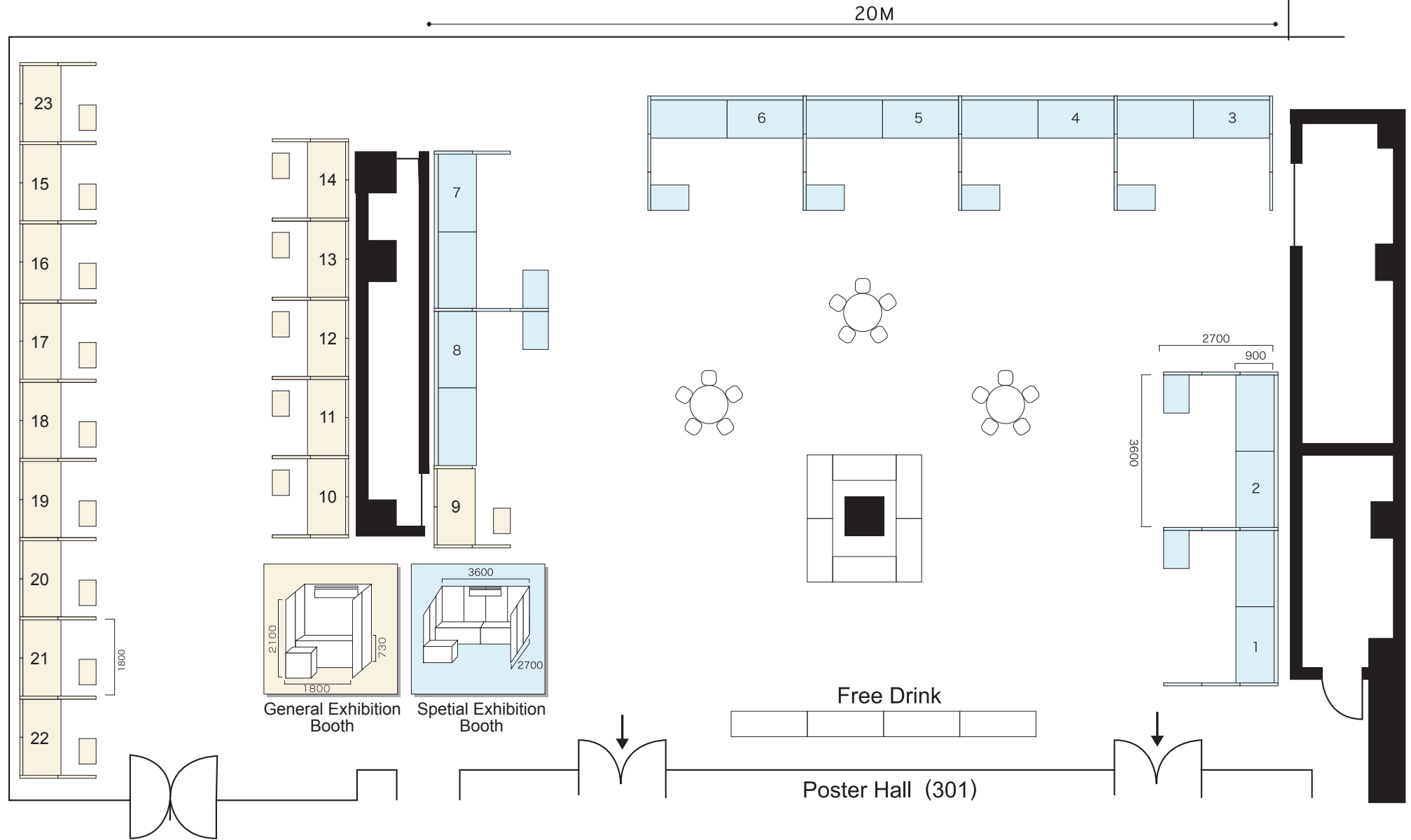

Special Company Exhibition

- 1 : Rittal K.K.
- 2 : Hitachi Zosen Corporation
- 3 : Yokogawa Electric Corporation
- 4 : D-TACQ Solutions Ltd.
- 5 : Melec Inc.
- 6 : ADVANET Inc.
- 7 : Cosylab
- 8 : Instrumentation Technologies, d.d.

General Company Exhibition

- 9 : MTT Corporation
- 10 : National Instruments Japan Corporation
- 11 : Mitsubishi Electric TOKKI Systems Corp.
- 12 : SANRITZ Automation Co., Ltd.
- 13 : Hytec Electronics Ltd.
- 14 : Orient Microwave Corporation
- 15 : TechMatrix Corporation
- 16 : ZTEC Instruments
- 17 : Meru Networks/NISSHO ELECTRONICS CORPORATION
- 18 : Aerotech KK
- 19 : Delta Tau Data Systems
- 20 : LHS. Incorporated
- 21 : GE Fanuc Intelligent Platforms Embedded Systems
- 22 : ARKUS Inc.
- 23 : MISH International Co., Ltd.